

# Overview

## **Document Title:** Accessible Version of Enabling Village (EV) Exhibition

### **Overview:**

This document provides the accessible version of the Enabling Village (EV) Exhibition installation, showcased during Enabling Village's 10th Anniversary celebration and the opening of EV's new extension, Vista, on 5 December 2025.

The EV Exhibition celebrates EV's first decade and highlights key milestones, signature initiatives, and meaningful partnerships from the past 10 years. The exhibition is designed as a series of **10 pillars**, with each pillar representing one theme or chapter of EV's journey.

Each pillar sits on a box-like base and is made up of two stacked cubes that feature photographs, captions, and information about EV's history and impact. The installation uses a blue-and-green colour palette throughout.

All pillars are **under 1.7 metres in height** and are numbered pillars **1 to 10** for the purpose of this document. The cubes can be rotated, allowing visitors to explore the different panels on each cube.

Three of the pillars have **acrylic display boxes** positioned at the top instead of a second cube. Each acrylic box contains physical objects related to the pillar's theme. Further descriptions of these items are provided in the corresponding pillar sections below.

# Pillar 1

## **PILLAR 1:**

### **[Acrylic Display]**

Located at the top of this pillar, is an acrylic box with different items displayed inside.

The items inside the box are from the Groundbreaking Ceremony in 2014. They include a red watering can; a framed photo of Former Minister for Social and Family Development, Mr Chan Chun Sing, and Former President Halimah Yacob, with 5 other members from the community standing around the newly planted Tembusu tree while holding shovels; and pebbles with well-wishes from the community and sector partners written on them.

### **Title: From Vision to Village: Building a National Movement for Inclusion**

Enabling Village by SG Enable is Singapore's first inclusive community space that brings to life how persons with disabilities can work, learn, live, and play as part of an inclusive society.







Image caption: Former site of Enabling Village: Bukit Merah Vocational Institute in 1973 to 2000s.



Image caption: Students at Bukit Merah Vocational Institute



Image caption: Former site of Enabling Village: Employment and Employability Institute (e2i), 2008 to 2014.



Image caption: Former site of Enabling Village: Employment and Employability Institute (e2i), 2008 to 2014.

### **Groundbreaking Ceremony in 2014**

On 3 July 2014, SG Enable broke ground for the construction of Enabling Village. The ceremony was attended by persons with disabilities, caregivers, voluntary welfare organisation leaders and community partners.





Image caption: Former Minister for Social and Family Development, Mr Chan Chun Sing, Mr Chan Heng Kee, Mr Philip Tan, Mr Sam Tan, and Mr Yuen Kuan Moon.

Fun Fact: This Tembusu tree can be found next to the Caregivers Pod!



Image caption: Shovel used at the Groundbreaking Ceremony. Pebbles containing well-wishes from the community and sector partners.

**Opening of Enabling Village** by then-Prime Minister Lee Hsien Loong on 2 December 2015 as Singapore's first inclusive community space, with a focus on training and employment of persons with disabilities.







## Pillar 2

## **PILLAR 2**

**Title: Designed for All: A Universal, Calming Space for Everyone**



Transformation of the Enabling Village from an old school building to a barrier-free space for all



Image caption: Before



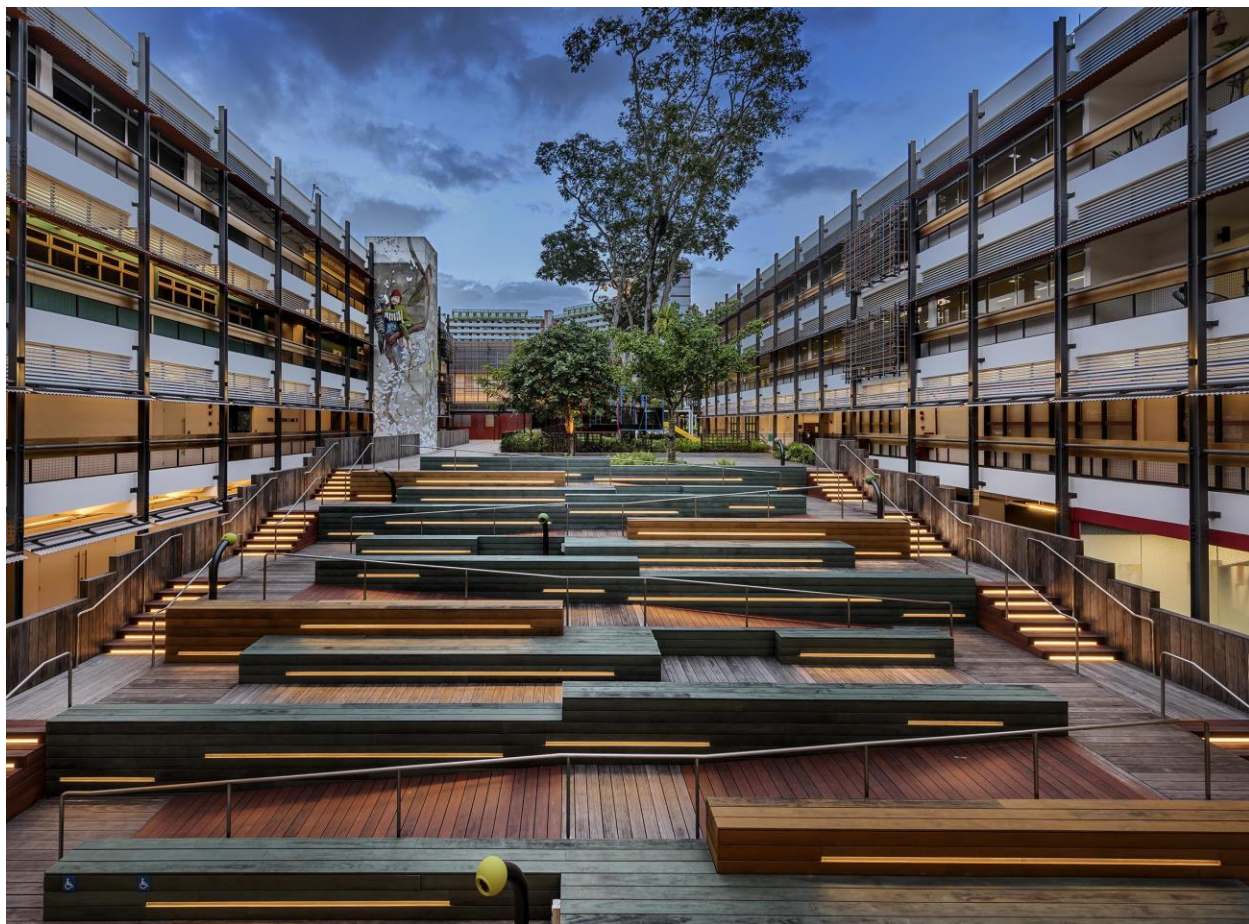

Image caption: Retrofitted for barrier-free access



Image caption: Braille on staircase railings for independent navigation for persons with visual impairment.



Image caption: A hearing loop system covers event spaces, transmitting audio directly to hearing aids.

Lush greenery becomes a green lung in the neighbourhood, providing a peaceful retreat and sensory-friendly space.





Image caption: Over 140 native and rare plant species attract wildlife including hornbills, kingfishers, butterflies, and damselflies.





Image caption: The Enable Lane is a central textured pathway that ensures accessibility for visual and physical needs. Its high contrast, tactile surface aids those with visual impairment, while its smooth surface allows wheelchair users to navigate with ease from Redhill Road to Jalan Bukit Merah.



Image caption: Calm rooms incorporate soft furnishings and adjustable lighting for a supportive and comfortable setting for individuals experiencing sensory overload or sensitivity to their surroundings.



Image caption: With room for two wheelchairs, the lifts at Vista block enable visitors using mobility devices to move freely.

### **Beyond Shared Spaces**

Universal design goes beyond common spaces, extending into tenant spaces with inclusive infrastructure such as sliding doors, low counters and accessible ramps.





Image caption: Mount Alvernia Outreach Medical & Dental Clinics is equipped with a wheelchair tilter and its staff are trained in supporting persons with special needs.

# Pillar 3

### **PILLAR 3**

**Title: Breaking New Ground: A Living Testbed Catalysing Inclusive Innovations Nationwide**





Image Caption: In 2016, with support from Lien Foundation, **Kindle Garden by AWWA** opened as Singapore's first inclusive preschool. The vision was clear: create a space where children of all abilities could grow and thrive.

Kindle Garden's approach is both intentional and innovative. With low teacher-to-child ratios and small class sizes, educators provide personalised attention while designing lessons that incorporate peer learning and cooperative play. Teachers work closely with AWWA's allied health professionals and early intervention specialists, creating individualised learning plans that unlock each child's potential, underpinned by a robust and well-rounded pedagogy.

The location within Enabling Village reinforces learning as well. Children can explore the lush, green surroundings while being immersed in an environment that normalises diversity and celebrates inclusion.

The success of Kindle Garden has attracted attention from fellow educators and international visitors, who have come for learning journeys and knowledge exchanges. Mainstream schools also visited to understand the model, leading to partnership with the Early Childhood Development Agency (ECDA) and broader conversations about inclusive education.





**Tech Able**, managed by SG Enable and SPD, provides assessment and training in assistive technology (AT), allowing individuals to test devices in real-life settings before purchase to ensure the right fit for work and independent living. Drawing from the experience at Tech Able, two new SG Enable-supported assessment centres will be launched from 2026, which will handle straightforward AT needs and reduce waiting times, while Tech Able continues to support more specialised assessments.



**Stroke Support Station (S3)** takes a holistic approach, combining rehabilitation and wellness with a supportive community that fosters hope and motivation among stroke survivors. Its success at the Village led to a second centre at Jurong Point, reaching more families and communities.



Image caption: Jason (left) is on the road to recovery with the help of S3's physiotherapists, such as Principal Physiotherapist Goh Shi Min.





Image caption: S3's commitment to innovation led to the S3 Innovation Lab, where social innovators, stroke survivors, and clinicians co-develop tailored rehabilitation solutions. Jason (right) tests a prototype from Omnilabs Research Pte Ltd.

**ActiveSG gym** at Enabling Village welcomes people with and without disabilities to work out side by side with inclusive equipment and fitness programmes.



Image caption: Success at the Village paved the way for Sport Singapore to commit to making all ActiveSG gyms inclusive by 2026.



Image caption: Mr Chong Siew Thong, a stroke survivor who frequents the gym shares, "It boosts my mental resistance to all matters in life. Training here gave me a goal and target to achieve, step by step—not big targets, but achievable weekly goals."

## Pillar 4



## **PILLAR 4**

### **Title: Empowering Through Work: Partnering Employers Across Sectors to Expand Inclusive Employment Pathways and Possibilities**



Image caption: Persons with disabilities receive job placement and job support through our partners like APSN, Autism Resource Centre (Singapore), MINDS and SPD.

The **Employability & Employment Centre (E2C)** by Autism Resource Centre (Singapore) (ARC) enhances the employability of individuals on the autism spectrum through training, job matching, and job support. It partners employers to create meaningful, structured roles and showcases inclusive employment practices.

At the Hive block, its enclave employment model enables groups of employees on the autism spectrum to perform scoped tasks in a supportive, coached environment.



Image caption: At E2C, a job coach trains a client in hard and soft skills, such as digitalisation, and communication skills.



Image caption: The Art Faculty, ARC's social enterprise, empowers artists on the autism spectrum through showcasing and the sale of their artworks embellished onto merchandise.

**i'mable Collective Space** supports inclusive employment in the design and arts sectors by providing a platform for pan-disability creatives to showcase their talents.











Image caption: Enabling Village resident guides with disabilities from **Ludus Lab** began



their pilot in the Village, and the programme has since expanded to offer accessible experiences at Sentosa and beyond.



Image caption: 'This is my second home. It is where I have grown, found support, and connected with people who see me for who I am, not my disability. For many of us in the community, this place gives us courage to dream bigger. For Singapore, Enabling Village shows how we can build a society where everyone can belong.'

Standing in the middle: Jackie Chionh, Docent Guide with Physical Disability, Ludus Lab

All social businesses in Enabling Village are committed to hiring, training or matching persons with disabilities with potential employers.



Image caption: **Inclus'** team-building activity where the participants need to communicate with one another to lower the hula hoop to the ground using only their index fingers, which allows them to develop clear communication skills.





Image caption: **Inclus** provides enrichment activities like piecing together LEGO Mindstorms, which requires participants to remain focused and follow instructions and troubleshoot.





Image caption: Inclus also conducts mock interview sessions for persons with disabilities to help them prepare for real interviews and build confidence and communication skills.



Image caption: Beyond a pet café, **Bailey and Patch** offers training for persons with disabilities in basic pet grooming, mainly washing, drying and combing.



Image caption: **MS Academy** provides training for persons with disabilities in music instrument repairs, creative arts, workplace readiness, and work attachments with partner organisations.



# Pillar 5

## **PILLAR 5**

**Title: Learning for Life: Building Capabilities of Persons with Disabilities, Caregivers, and Employers through the Enabling Academy**



Image caption: **Enabling Academy**, Singapore's disability learning hub, partners with training providers and social service agencies to offer lifelong and vocational training for persons with disabilities, while equipping employers, co-workers, and caregivers with resources to support inclusive workplaces and independent living. It also promotes accessibility practices to ensure learning opportunities are open and inclusive to all.



Image caption: **Samsui Kitchen's** vocational training guides trainees from classroom lessons in food prep and customer service, to hands-on kitchen practice, and finally to job placements in hotels, restaurants, and commercial kitchens.

The **School-to-Work (S2W) Transition Programme** is a multi-agency initiative by the Ministry of Education, Ministry of Social and Family Development, and SG Enable, in partnership with special education schools to transit graduates into employment.





Image caption: Special education school graduands of the School-to-Work Transition Programme.



Image caption: Special education school graduands of the School-to-Work Transition Programme.





Image caption: School-to-Work trainees are placed in group internships or open



employment with job coaching support in various roles.



Image caption: School-to-Work trainees are placed in group internships or open employment with job coaching support in various roles.



Image caption: Partnership between DBS Foundation and SG Enable to equip persons with disabilities and caregivers with financial and digital literacy skills. President Tharman Shanmugaratnam observes and tests a training programme delivered with DBS volunteers.

**Empowering persons with disabilities with independent living skills**



**Disability inclusiveness training for Employers, Businesses and Organisations**





Image caption: Developed in collaboration with The Ascott Limited, the 'Disability Inclusion for Hospitality Professionals' programme offers hands-on experience for learners to create an inclusive experience for all. The course is available to the public at Ascott Centre for Excellence.



Image caption: "The course helped me understand what to look out for when serving persons with disabilities, and I now feel more confident offering help in a respectful and professional way. The tips and real-life examples were easy to follow and very relevant. It's helped me become more equipped to support all guests with care and understanding."  
Ms Hasliza Yaacob, Participant of Disability Inclusion for Hospitality Professionals.



# Pillar 6

## **PILLAR 6**

### **Title: Providing Support and Respite: A Community That Shares the Load and Celebrates Caregivers**



Image caption: The Caregivers Pod is a versatile space for caregiver support and gatherings, open to all seeking a welcoming place to connect.



Image caption: The village hosted the first **CaringSG** CARECarnival in 2023 where caregivers learnt about resources for mental wellness, caring for their physical health and support groups/networks for caregivers.





Image caption: The village hosted the first **CaringSG** CARECarnival in 2023 where caregivers learnt about resources for mental wellness, caring for their physical health and support groups/networks for caregivers.



Image caption: Caregivers participated in the Importance of Caregiver Safety workshop by APSN Learning Hub at the Caregivers Pod, learning practical strategies to identify and manage meltdowns with confidence and care.



Image caption: Caregivers participated in the Importance of Caregiver Safety workshop by APSN Learning Hub at the Caregivers Pod, learning practical strategies to identify and manage meltdowns with confidence and care.





Image caption: Caregivers participated in the Importance of Caregiver Safety workshop by APSN Learning Hub at the Caregivers Pod, learning practical strategies to identify and manage meltdowns with confidence and care.



Image caption: CaringSG's R.E.S. Studios (Resilience, Empowerment, and Sanctuary) provide emotional support, skills training and respite for caregivers. Together, these studios create a holistic support for the entire family, ensuring that no caregiver walks alone.



Image caption: The Future Care Planning Resource Centre strengthens sector capabilities and engages community partners to empower persons with disabilities and their caregivers to plan early and confidently for their long-term care.





Image caption: Discussion on future planning with specialist speakers from CPF Board, Pro Bono SG, and Home Nursing Foundation. Part of Enabling Academy's Money Matters series, it empowers caregivers to plan for their loved ones' long-term needs.



Image caption: "The environment at Enabling Village is thoughtfully designed to embrace Japheth's curiosity. Here, my son and I feel a profound sense of comfort and belonging. The community buzzes with life, making it feel like a home where everyone is welcome and valued."

Mr Daniel Joshua, caregiver to his son Japheth who has autism.





Image caption: The Take-A-Break (TAB) programme by SPD with support from SG Enable, provides escort services, personal care assistance, and social activities for persons with disabilities. These services give caregivers time to rest or attend to errands with peace of mind.



# Pillar 7

## **PILLAR 7**

### **Title: Celebrating Play: Inclusive Offerings for All Abilities**

With curated inclusive offerings for persons with disabilities and the wider community, the Village offers a vibrant space to connect, learn, and grow. Through arts, sports, music, and everyday interactions, it demonstrates how inclusive design fosters participation and builds stronger communities.



Image caption: S3 members attending aqua therapy classes at Little Splashes.



Image caption: **Little Splashes**, Singapore's first fully accessible private swim school, offers inclusive classes for all ages - from children to seniors. Its facility features accessible changing rooms, a ramp for mobility aid users, and a heated pool that supports muscle relaxation. Teachers are trained to work with students with special needs, ensuring an inclusive and supportive learning experience.





Image caption: **Wildflower Studio**, home to art and a community of rescue cats, offers a unique experience for art and cat lovers. Its 'Paint and Chill in Monochrome' programme uses monochromatic art therapy to help individuals process emotions, release feelings, and build coping strategies for stress and anxiety.



Image caption: **Voices of Singapore**, the nation's largest singing organisation with over 30 groups and almost 2,000 members, champions inclusivity through its community impact programmes, welcoming singers of all abilities and ages, from children with special needs to seniors, fostering a shared love of choral music.





Image caption: **Voices of Singapore**, the nation's largest singing organisation with over 30 groups and almost 2,000 members, champions inclusivity through its community impact programmes, welcoming singers of all abilities and ages, from children with special needs to seniors, fostering a shared love of choral music.





Image caption: **Be Kind SG** envisions a kind, inclusive society for all, focusing on persons with disabilities, including those with intellectual disabilities and autism. Through initiatives like Play.Able, it provides a safe, judgement-free space where children of all abilities can play, connect, and develop social skills.



Image caption: **Be Kind SG** envisions a kind, inclusive society for all, focusing on persons with disabilities, including those with intellectual disabilities and autism. Through initiatives like Play.Able, it provides a safe, judgement-free space where children of all abilities can play, connect, and develop social skills.





Image caption: **InSchool** equips neurodivergent children aged 7 to 12 with functional



living skills through personalised, hands-on learning that builds confidence, independence, and daily routines.



Image caption: **InSchool** equips neurodivergent children aged 7 to 12 with functional

living skills through personalised, hands-on learning that builds confidence, independence, and daily routines.





Image caption: **InSchool** equips neurodivergent children aged 7 to 12 with functional

living skills through personalised, hands-on learning that builds confidence, independence, and daily routines.



Image caption: **AMGD Superfood Restaurant**, Singapore's first halal, healthy, and inclusive superfood restaurant, serves nutritionist-designed, zero-waste meals that create employment for persons with disabilities and underserved communities.





Image caption: **EatTalk** at Enabling Village is a training and deployment hub for persons with disabilities interested in the F&B sector. It also employs persons with disabilities alongside their caregivers, enabling shared on-the-job training and meaningful employment.





Image caption: **Mad Roaster** supports persons with disabilities in building livelihoods - showcasing Christian Outreach for the Handicapped (COH) students' artworks at the Slow Bar and providing APSN students with bakery job training at Enabling Village.

# Pillar 8



## **PILLAR 8**

### **[Acrylic Display]**

Located at the top of this pillar, is an acrylic box with different items displayed inside.

The items inside include a National Day Parade tote bag from 2020; and a framed photo of Former President Halimah Yacob standing with a group of students and adults wearing masks spaced out in a hall. The students are holding up decorated tote bags with various colourful designs made by them. Display boards with more artwork line the back of the hall.

There is also a caption in the display that reads:

#### **National-wide Support for Inclusion**

President Halimah Yacob met the artists behind the 20 designs featured on the Singapore Together Packs for the National Day Parade (NDP) in 2020 at Enabling Village. In line with the NDP theme, “Together, A Stronger Singapore”, these designs showcase the artists’ love and aspirations for Singapore, and their appreciation of those supporting the COVID19 battle.

**Title: Inclusion in Action: Engaging Events and Programmes That Enrich Communities**



Image caption: Enabling Village curates a regular line-up of inclusive programmes that range from arts, culture, sports, education to innovation and technology. These programmes foster interaction and integration between persons with disabilities and the wider community, as well as promote greater awareness and positive mindsets about disability.

### **Enabling Lives Festival and Enabling Village Open House**

As part of the Enabling Lives Festival, the Enabling Village Open House invites visitors to explore inclusive spaces through guided tours, live performances, hands-on workshops, and festive shopping at the i'mable Collective Market.





Image caption: i'mable Collective Market promotes inclusive employment in design and arts by giving pan-disability creatives and their caregivers a platform to showcase products and connect with the community.

### **Enabling Village's 10th Anniversary Community Mural**

In commemoration of Enabling Village's 10th Anniversary and SG60, over 650 community stakeholders and disability sector members co-created a mural titled 'Garden of Possibilities', symbolising inclusion and the community's collective spirit.



Image Caption: In commemoration of Enabling Village's 10th Anniversary and SG60, over

650 community stakeholders and disability sector members co-created a mural titled 'Garden of Possibilities', symbolising inclusion and the community's collective spirit.



Image Caption: In commemoration of Enabling Village's 10th Anniversary and SG60, over 650 community stakeholders and disability sector members co-created a mural titled 'Garden of Possibilities', symbolising inclusion and the community's collective spirit.

## **Inclusive Programmes**

Enabling Village features events across and beyond arts, culture, innovation, technology, and sports, including dialogues, human libraries, performances, workshops and more. It fosters positive perceptions of persons with disabilities, inspires inclusive action, and makes Enabling Village a vibrant hub, while partners get venue support and the chance to showcase ideas.





Image caption: 'Everybody's Book Club by Shoes Theatre Collective' - a fun and interactive storytelling session where participants explore different types of vision loss, discover Braille, and learn how people navigate the world through touch, sound, and imagination.



Image caption: Nanyang Technological University's Wee Kim Wee School of Communication and Information x SG Enable - an interactive filmmaking workshop where persons with disabilities worked with professional filmmakers to create short films.



Image caption: Movies Under The Stars by Cinewav - an outdoor movie night where audiences can unwind and enjoy films under the open sky.





Image caption: 3D Printing and Co-Creation of Assistive Devices by SalvageGarden Makerspace - an experiential workshop where participants use 3D printing to create assistive devices.

# Pillar 9



## **PILLAR 9**

### **[Acrylic Display]**

Located at the top of this pillar, is an acrylic box with different items displayed inside.

The items inside include an award plaque that says ULI Global Awards for Excellence 2022 Winner Enabling Village Singapore; and a book that features the winners from the President's Design Award 2016.

There is also a caption in the display that reads:

### **Celebrating Enabling Village's Achievements**

Enabling Village was awarded the ULI (Urban Land Institute) Asia Pacific and Global Awards for Excellence 2022 in recognition of its inclusive design and community impact. As one of the six global winners, the Village was lauded for creating a model that integrates training, employment, and disability services within an accessible community space.

**Title: Shining Bright: A Beacon of Inclusion Recognised Nationally and Globally**



### **Awards and Accolades**

1. President's Design Award 2016 (Design of the Year)
2. BCA Universal Design Mark Award 2016 (Platinum)
3. SIA Architectural Design Award 2016
4. Landscape Excellence Assessment Framework (LEAF) 2016 (Outstanding Project)
5. DFA Design for Asia Awards 2017 (Grand Award with Special Mention)
6. Featured in 16th International Architecture Exhibition by La Biennale di Venezia (Venice Biennale) 2018
7. Innovative Practice Award 2019 by Zero Project
8. Landscape Industry Association (Singapore) (LIAS) Awards 2021
9. ULI (Urban Land Institute) Asia Pacific and Global Awards for Excellence 2022
10. Singapore Good Design Awards 2025 (SG Mark and Gold Award) for Accessible Sights

### **Thought Leadership Events on Disability Inclusion**



Image caption: Since 2023, SG Enable has partnered with the Austria-based non-profit initiative by the Essl Foundation, Zero Project, to share expertise and ideas through symposiums on social innovations that advance the United Nations Convention on the Rights of Persons with Disabilities

### **Hosting International Delegates to Advance Inclusion Exchange**





Image caption: Mdm Ho Ching, wife of then-Singapore's Prime Minister, hosted Mdm Kim Jung-Sook, then First Lady of the Republic of Korea, at Enabling Village. She learned about the various facilities and visited The Art Faculty.



Image caption: Led by His Excellency Dato Seri Setia Awang Haji Nazmi Bin Haji Mohamad, Minister of Culture, Youth and Sports, and Her Excellency Hajah Nor Ashikin Binti Haji Johari, Permanent Secretary (Community), SG Enable hosted the Bruneian delegation at Enabling Village for an experiential tour of inclusive living, working, and recreational spaces for their planning of a facility for disability agencies in Brunei.

# Pillar 10



## **PILLAR 10**

### **Title: It Takes a Village: Honouring the People and Partners Who Made It Possible**



### **Our Generous Donors**

The expansion of Enabling Village's impact as an inclusive community space is made possible by the generous support of:

- Tote Board
- Wilmar International Limited
- United Overseas Bank Limited
- Mr Kuok Khoon Hong
- Mr Loh Kiong Poot
- Makena Capital Management LLC
- Mr Ng Kok Song and Mr Ray Dalio
- The Good Blockchain and Automata Network
- Hustle & Bustle Group
- Ms Dawn Marie Toh
- Mr Lim Leong Guan
- GIC Pte Ltd
- Ms Natasha Goh
- Chew How Teck Foundation

### The Enabling Village Founding Donors

- Tote Board
- Community Chest (Care & Share Movement SG50)
- United Overseas Bank Limited
- Lee Foundation
- Singapore Telecommunications Limited
- Singapore Technologies Engineering Ltd
- SBF Foundation
- Lien Foundation
- Sunray Woodcraft Construction Pte Ltd
- Standard Chartered Bank
- WOHA

### Our Programme Supporters in the Village

- DBS Foundation
- Goh Chok Tong Enable Fund
- Ministry of Social and Family Development
- SkillsFuture Singapore
- Temasek Trust
- Tote Board
- Workforce Singapore

### Honouring Our Board Members

Past Board Members (Name: Period of Service)

- Chan Heng Kee (then-Chairman): 31 Mar 2013 – 1 May 2016
- Chew Hock Yong (then-Chairman): 1 May 2016 – 15 Apr 2022
- Ong Toon Hui: 31 Mar 2013 - 31 Dec 2013
- Charlotte Beck Gek Suan: 31 Mar 2013 – 1 Jan 2014
- Anjan Kumar Ghosh: 1 Jan 2014 – 31 Dec 2019
- Chew Seow Chien: 1 Jan 2014 – 31 Dec 2022
- Chia Yong Yong: 1 Jan 2014 – 31 Dec 2022
- Chong Yoke Sin: 1 Jan 2014 – 31 Dec 2023
- Rebecca Teo Yock Lan: 1 Jan 2014 – 31 Dec 2017
- Sim Sin Sin Seraphine: 1 Jan 2014 – 31 Dec 2017
- Suhaimi Bin Salleh: 1 Jan 2014 – 31 Dec 2022
- Tina Hung @ Ong Geok Tin: 1 Jan 2014 – 28 May 2015
- Wong Meng Ee: 1 Jan 2014 – 31 Dec 2022
- Zee Yoong Kang: 28 Feb 2014 – 31 Dec 2019
- Chai Lee See: 27 May 2014 – 1 Jan 2016
- Tan Lay Kuan Jean: 28 May 2015 – 31 Dec 2023

- Lynn Ng Hui Wah: 1 Jan 2016 – 31 Dec 2023
- Clara Goh Yau Hong: 1 Jan 2018 – 31 Dec 2024
- Ng Cher Pong: 1 Jan 2018 – 31 Dec 2019
- Tan Kwang Cheak: 1 Jan 2018 – 31 Dec 2022
- Xie Yao Quan: 1 Jan 2018 – 31 Dec 2024
- Tan Li San: 1 Jun 2020 – 31 Dec 2022
- Sim Gim Guan: 1 Jan 2020 – 31 May 2020
- Lim Teck Kiat: 1 Jan 2023 – 31 Jul 2023

Current Board Members (Name: Period of Service)

- Moses Lee Kim Poo (Chairman): 16 Apr 2022 till present
- Lee May Gee (CEO): 4 Dec 2024 till present
- Lim Hong Huay: 1 Jan 2020 till present
- Chern Siang Jye: 1 Jan 2023 till present
- Gan Seow Kee: 1 Jan 2023 till present
- Haslina Mohamed Hassan: 1 Jan 2023 till present
- Michael Ngu King Teng: 1 Jan 2023 till present
- Peter Tan Chong Tze: 1 Jan 2023 till present
- Sybil Lau E Jen: 1 Jan 2023 till present
- Cynthia Leow Sheue Wen: 1 Aug 2023 till present
- Neo Sing Hwee: 1 Jan 2024 till present
- Dilys Charmaine Boey Mengyi: 1 Jan 2024 till present
- Gan Ai Im: 1 Jan 2024 till present
- Vikna Rajah: 1 Apr 2025 till present
- Mark Tham Mun Chun: 1 Apr 2025 till present

*Information updated as of 30 Nov 2025.*





Image caption: Celebrating partnership and community at Enabling Village Tenant Get-Together sessions.



Image caption: Celebrating partnership and community at Enabling Village Tenant Get-Together sessions.

### **Our Current Tenant Partners**

- ActiveSG Gym
- AMGD Superfood Restaurant
- Art Bar (Community Project with Starbucks) by Autism Resource Centre (Singapore)
- Bailey & Patch Café
- Be Kind SG (Play.Able)
- CaringSG Limited
- EatTalk
- Empact
- Employability & Employment Centre (E2C) by Autism Resource Centre (Singapore)
  - ARKADEMIE
  - EDEN + ELIE
  - Fashion Makerspace
  - National Library Board
  - Re-store Enterprise
  - The Animal Project
  - United Overseas Bank

- HEART@Fei Yue
- i'mable Collective Space
  - Foreword Coffee Roastery and Academy
  - Hullabaloo
  - Postboy Coffee
  - weareSuper
- InSchool X Inclus X Starships Flowers and Balloons
- Kindle Garden Preschool by AWWA
- Little Splashes Aquatics
- Mad Roaster's Slow Bar
- MINDS
- Mount Alvernia Outreach Medical & Dental Clinics
- MS Academy by Music Solutions
- S3 @ Enabling Village Centre for Stroke Recovery
- S3 Innovation Lab
- Samsui Kitchen
- SPD Contact Centre
- SPD Learning Lab
- Tech Able by SG Enable and SPD
  - Singtel Enabling Innovation Centre
  - ST Engineering Enabling Technology Centre
- The Art Faculty by Autism Resource Centre (Singapore)
- The Eyecare Village by Eyeviser
- TOUCH Centre for Independent Living
- Voices of Singapore
- Wildflower Studio

### **Former Tenant Partners**

- BIM Studios
- Canine Programme Centre by EQUAL
- iFIT Gym
- Inclus X SF Fruits
- Island Creamery
- Juice Stories
- Junior Art Lab
- Mum's Café
- NTUC FairPrice
- Professor Brawn Bistro by Autism Resource Centre (Singapore) + Gong Cha
- ProfilePrint
- Singapore Civil Defence Force
- Soul Food Enterprise
- Superhero Me
- The Sapling by Shatec
- Employability & Employment Centre (E2C) by Autism Resource Centre (Singapore)
  - DataPost
  - Edible Garden City



- Green Corridor
- My Art Piece
- Tiong Bahru Bakery

*Information updated as of 30 Nov 2025.*

### **Our Everyday Heroes at Enabling Village**



Image caption: SG Enable staff



Image caption: Celebrating the service staff who keep the Village clean, welcoming and full of heart.





Image caption: Celebrating the service staff who keep the Village clean, welcoming and full of heart.



Image caption: In conceptualising Enabling Village in 2014, Ms Shirin Kwek (SG Enable staff) shared, "I learned to look beyond my assumptions and see design as a bridge built



with empathy, where understanding and heartfelt creation come together."